



Life - Health - Happiness

# Electrolyzed-watertreatmentdevice User Manual

Model

- PL-220
- PL-222
- PL-320
- PL-325
- PL-520
- PL-525
- PL-725



- Before using the instrument, be sure to carefully read through the instructions contained in this manual.
- The pH-value mentioned in this manual and panels varies depend on different water quality.
- CHANSON shall not be liable for any malfunctions or accidents occurred from the user's ignorance and misuse during installation cause.
- Warranty Card should be stamped with the original purchase date and stamp of the store.
- WARRANTY IS VOID IF Warranty Card without the stamp of the original purchase date and the stamp of retailer. WARRANTY IS ALSO VOID if Warranty Card is lost.

# The Feature and benefit of electrolyzed alkaline water

## What are the benefits of electrolyzed alkaline water ?

1. Alkaline electrolyzed water is an antacid. Antacids help to treat the acid of human body to prevent from ill and chronic disease.
2. Alkaline electrolyzed water function as an antioxidant and seeks out free radicals to prevent from ill and chronic disease.
3. Alkaline electrolyzed water increases the Lactobacillus count and improves fermentation.
4. The alkaline electrolyzed water molecule structure (groups of H<sub>2</sub>O molecules) size is reduced. It is easy to be absorbed by drinking and accelerates the metabolism to keep you young and healthy.
5. There're more iron minerals in alkaline electrolyzed water than ordinary water to satisfy daily mineral requirement.
6. Acid electrolyzed water could be used for beauty salon · face washing · and antibacterial purpose.

## Suggestions for drinking electrolyzed water :

1. The first section of alkaline electrolyzed water : The pH-value lies between 8.0 and 8.5. It's for first time to drinking and should range between 20-35 years old.
2. The second section of alkaline electrolyzed water : The pH-value lies between 8.5 and 9.0. It's for that people used to drink alkaline electrolyzed water and also good for people of ages of 35-45 years old.
3. The third section of alkaline electrolyzed water : The pH-value lies between 9.0 and 9.5. For Ages range above 45 years old and daily drinking. It's good to improve some chronic diseases.
4. The forth section of alkaline electrolyzed water : The pH-value lies between 9.5 and 10. For food cleaning and odors.
5. The first section of acid electrolyzed water : The pH-value lies between 5.0 and 6.0 and it's light acid. For skin cleaning and shrinking the cell formation.
6. The second section of acid electrolyzed water : The pH-value lies between 3.5 and 5.5. and it's mild acid. For dish washing · and antibacterial purpose.

※ You can benefit most from drinking electrolyzed water when :

(1) You feel hungry before meals.

(2) Between half hour before meals and 2 hours after meals.

※ It influences the process electrobath that most public water supplies provide hard water in Taiwan. Please clean and care the electrobath periodically.

# Contents

1.Safety and Misuse Warnings	Page 2~3
2.Installation guide and diagrams	Page 4~6
3.The instruction of pH-value determination	
The instruction of Changing filters	Page 7
Using the tank for calcium powder	
4.Using electrolyzed-water treatment device	
Cleaning the electrobath	Page 8
5.Using the device PL-220/222	Page 9
6.Troubleshooting for PL-220/222	Page 10
7.Using the control panel of PL-320/325/520/525	Page 11
8.Using the control panel of PL-725	Page 12
9.The instruction of control panel for PL-320/325/520/525/725	Page 13~17
10.The instruction of LED display for PL-320/325/520/525/725	Page 18
11.Setting of water quality for PL-320/325/520/525/725	Page 19~20
12.Troubleshooting for PL-320/325/520/525/725	Page 21
13.Operations during the suspension period of water supply or electric power	Page 23
14.Filter maintenancerecord	Page 24

## Safety Precautions

MUST follow the instructions.

Read carefully the instructions contained in this manual. Please follow the instructions below to prevent the misuse and avoid injury to the user and other persons as well as damage to property.

- ▶ If instructions ignored and applied incorrectly, creates the injury or damage which is labeled by the following symbols.
- ▶ Please follow the instructions below.



### Warning

This symbol indicates warning that, if ignored or applied incorrectly, creates the danger of death or serious personal injury.



### Caution

This symbol stipulates matters that have the risk of causing death or serious injury if the product is operated incorrectly while ignoring this indication.



This symbol (⊘) means that the indicated action must not be performed. Indications within or nearby this symbol are specifically prohibited.



This symbol (ⓘ) means that the indicated action must be performed.



### Warning

Decompilation or disassembly is prohibited. Don't try to disassemble, maintenance, rebuild, or alter by yourself.



To disassemble creates the risk of fire and electric shock.

Please clean the dust or dirt over the outlet periodically.



If the dirt or dust from getting on the outlet, that will create the risk of electric shock by humanity.

Avoid multi-socket and household extension cords. Do not over voltage. nominal input voltage only for AC 110V.



Using multi-socket and household extension cords can create the risk of fire by heating.

Do not damage power cord and outlet.



- Positioning by brad nails.
- Power cord was worn.
- Rebuild or alter by yourself.
- Twist or bend the power cord .
- Pull on the power cord
- Put heavy weight on power cord.
- Bend power cord as loop

Keep using worn power cord or outlet creates the risk of fire, electric shock, and short circuit.

Do not touch socket with wet hands.



That creates the risk of electric shock and injury.

Power plug must be plugged in completely



Do not use worn socket and loose plug.

Do not use unqualified water.



Water without anti-bacteria process or moving the hazard material out creates the risk of ill. Qualified water supply is recommended.



If device fall into water, please unplug from the electrical socket and stop using.

Please contact your original retailer or an authorized service provider.

## Safety Precautions

MUST follow the instructions.

### Caution

Do not drink the water which pH-value is over 10.



That will create the risk of injury. The water which pH-value is around 9.5 is recommended. The third section of alkaline electrolyzed water is also recommended.



Before the first appliance of each day, please let the water flow freely about 0.6 liter (about 15 seconds) and then begin to use.

Avoid using aluminium containers which anti-alkali ability is weak. Avoid using copper containers without anti-acid ability

For electrolyzed alkaline water or clean water, please store it at clean closed containers. Drink up in 1 day at normal temperature. Drink up in 2 days for storing at refrigerator.



Using such containers will cause them to discolor or to be worn.



As chlorine in water is removed, it's easy to be added to cause injury.

Do not use unqualified water.

If pre-filter is installed and being absent without producing electrolyzed alkaline water more than 2 days, MUST turn off the water inlet switch.



- Weak acid water
  - Water from drainage pipe
  - Water from outlet during electrode cleaning
- ※ May cause uncomfortable feeling.



May cause water leakage and water pipe burst because of high pressure.

The following persons should contact doctor before using weak acid water.

For drinking electrolyzed alkaline water for the first time, please drink 1 or 2 cups of the first section of alkaline electrolyzed water daily. After 2 weeks and body can accept alkaline electrolyzed water, then drink the second or the third section of alkaline electrolyzed water.



- Low skin resistance .
- With over-sensitive skin.



To drink highly alkaline water may cause uncomfortable feeling.

Do not fill with hot water with the temperature over 60° through pre-filters or device.

In a hard-water area (Taiwan), electrodes cannot function properly. Avoid being dysfunctional and losing of water quality, please clean and maintenance periodically.



That may cause the damage of filters and device.















Contact our service providers about fees of the related maintenances.

# Installation guide and diagrams

## Parts

Before operating, please check the following parts. If any shortage, please contact agents. The related parts may vary depends on different models. Please check them all.

Switch and parts	The related accessories/parts in device				Consumable
  	  	  	 		<p>Branch switch</p> <p>Outlet pipe</p> <p>Pipe shaft-male screw type</p> <p>Outlet pipe</p> <p>Sucker</p> <p>Inlet outlet pipe</p> <p>Pipe clip X2</p> <p>Frame</p> <p>Plastic expansion bolt X2</p> <p>Nails X2</p> <p>Tank for calcium powder</p> <p>pH indicator dye</p>

## Installing branch switch

### Installation Method 1

If your stopcock is European style or American style (see the following figure).

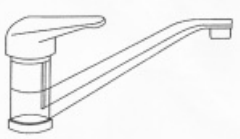
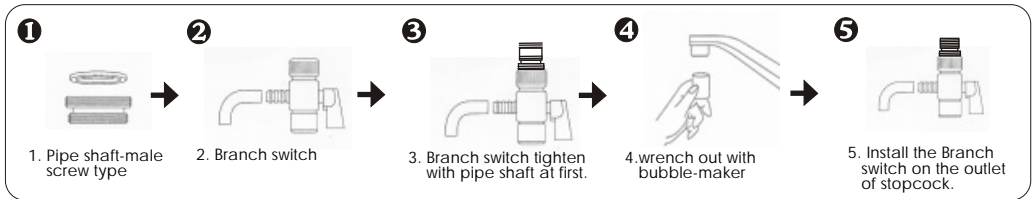

Figure 1

A. If the outlet of stopcock with female screw type (below figure 1), installation steps :

- 1 · Assemble branch switch which is tighten with pipe shaft. (Step 1.2.3)
- 2 · Wrench out with bubble-maker of stopcock (Step 4).
- 3 · Tighten the branch switch with the stopcock and a washer.
- 4 · The handler of branch switch could be right or left side. It's different by personal habit.



B. If the outlet of stopcock with male screw type (Right figure 2), installation steps :

Wrench out with bubble-maker of stopcock and wrench in with the branch switch. If any leakage, please wrench manually until stop the leakage. Before tightening branch switch, please confirm the washer is in branch switch.

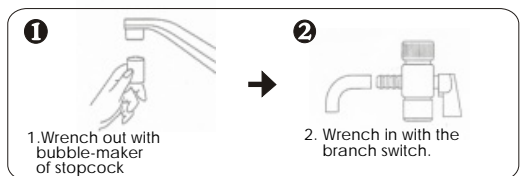
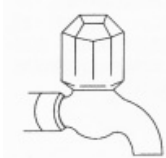

Figure 2

## Installation Method 2

installation steps : (see right figure)



- 1 · Put the constraining into cock.
- 2 · Choose which innering and put it into cock.
- 3 · Tighten with constraining ring.
- 4 · Tighten branch switch.

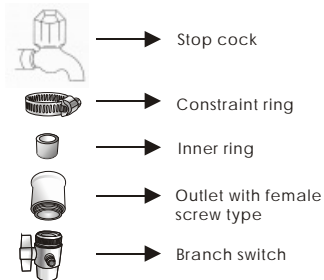

### Stopcocks can not install branch switch



※ can not install on stopcock with special type, the diameter of screw except 22 mm, or different diameter of outlet.

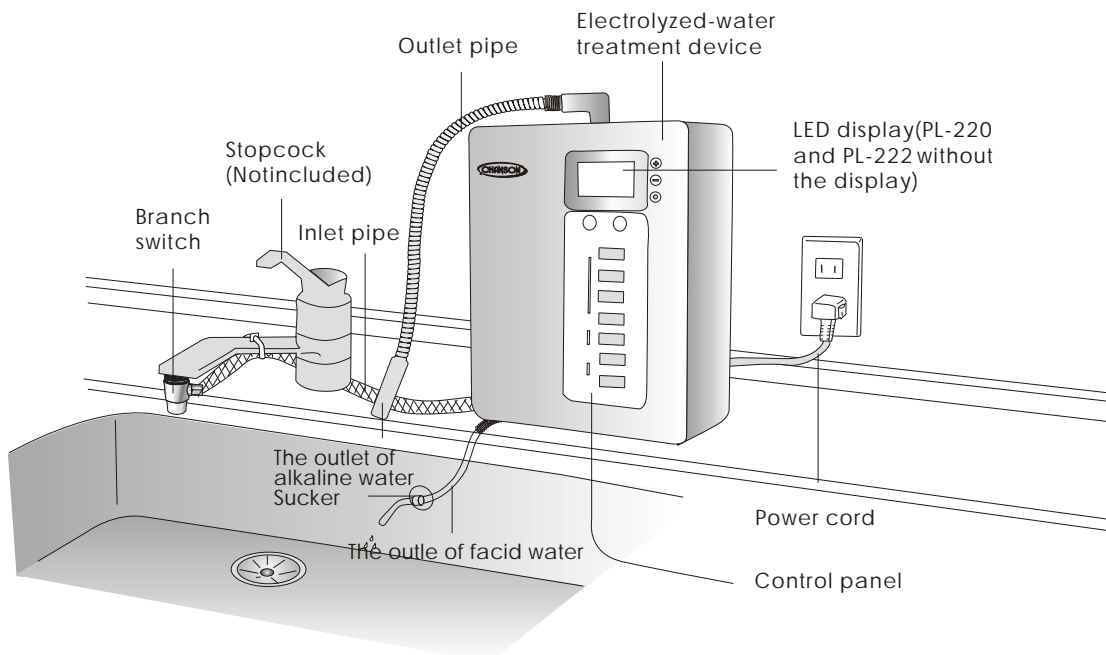

### Operation procedure

1. Confirm and complete the installation of stopcock and branch switch.
2. Turn the valve of branch switch upward.
3. Confirm the device is secured on the frame properly.
4. Make sure pushing the plug into socket.
5. Flow freely alkaline water for 3~4 minutes (for the drainage of air in the device)
6. Make sure is there any water flowing from (alkaline) outlet pipe and (acid) drainage pipe.
7. pH-value determination (please use the pH indicator dye included, see P.7)

# The connection between device and pipes

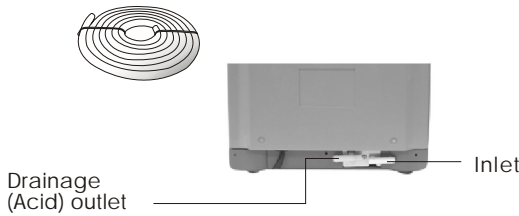

1. Find the inlet pipe in accessory pack.
2. Tailor the inlet pipe in the desired length.
3. Tailor the drainage pipe in the desired length.
4. Connect pipes by reference of left figure.
5. Connect the other side of inlet pipe to the inlet of branch switch.
6. Connect the other side of drainage (acid) pipe to sucker which is included in accessory pack.

# Instruction of the back of device

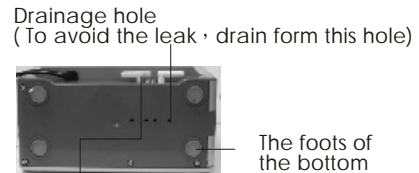
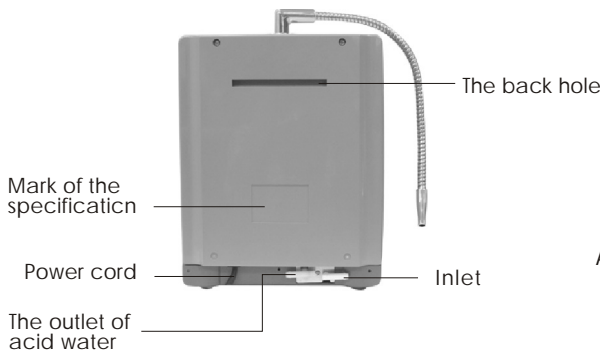

Adjust the portion of drainage acid water.



The portion of alkaline vs acid id is 6:4

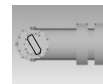

The portion of alkaline vs acid id is 7:3

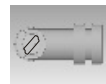

The portion of alkaline vs acid id is 8:2

# How to mount the device on wall

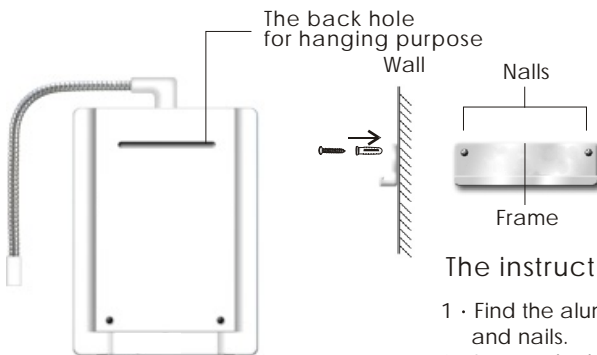

## The instruction of installation

- 1 · Find the aluminum frame, plastic expansion bolts, and nails.
- 2 · Locate the hole positions of frame on the wall.
- 3 · Drill the hole on the wall.
- 4 · Put the plastic expansion bolts in the holes.
- 5 · Tighten the nails in bolts.
- 6 · Put the device on the aluminum frame.
- 7 · All procedures are finished.



# The instruction of pH-value determination

The following is the determination procedure.

- 1 Find the dropping bottle of pH indicator dye in accessory package. Two drops of the dye is added to a test tube.
 
- 2 Let the generated water flows freely for 10 seconds (for precise sampling).
- 3 Add some sampled water in the test tube. Cover and mix well.
- 4 In a bright environment, pH-value is determined visually by visual comparison with standard color charts.

## Caution :

Do not splash in eyes, taste, or swallow

- IF swallowed. Drink water to dilute concentration. IF in eyes, flush eyes with plenty of water. Seek Medical Aid immediately
- MUST cover the bottle tightly. And put it in a place where children cannot reach.
- pH indicator dye have a 1-year life cycle. If necessary, please contact the nearest dealer.

# The instruction of Changing filters

The procedure of changing filters

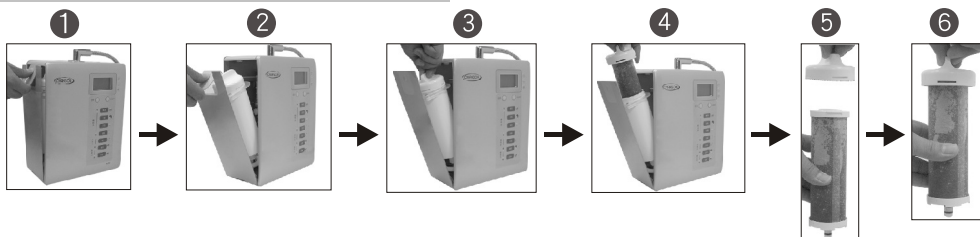

1. Push the switch of filter cartridge.
2. Pull up the filter cartridge.
3. Wrench out the top cap of filters bottle.
4. Take out the filter.
5. Rotate the top cap anticlockwise to remove filter.
6. Put a new filter and rotate clockwise to tighten.
7. Put the filter into the bottle and tighter the top cap.
8. Pull the switch of filter cartridge.
9. Reset the counter (it varies depend on different models, please refer the reset counter procedure of each model.)
10. After flowing water freely for 1~2 minutes, the device is ready.

# Using the tank for calcium powder

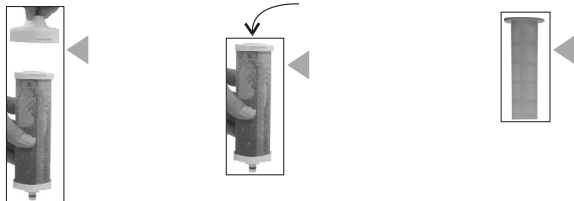

- 1 Rotate the top cap of filter bottle.
- 2 The center hole of the filter (indicated by the arrow) is the hole to put the tank of calcium powder
- 3 Find the tank of calcium powder in the accessory pack.
- 4 Put some calcium powder in the tank (You can buy calcium powder from drug store or retailers).

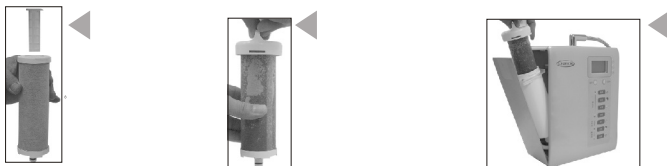

- 5 Put the tank into the filter.
- 6 Tighten the top cap.
- 7 Put filter into filter bottle.
- 8 It's done.

## Tips :

1. The purpose of adding calcium powder is for improving soft-water in order to reach the desired pH-value. (In a hard-water area (Taiwan), it's not recommend to add that.)
2. Before adding calcium powder, MUST clean the tank to prevent from the aggregate of powder. It may cause dirt in water or aggregate on the electrode.

# Using electrolyzed-water treatment device

## The instruction of operation

- 1** Turn the valve of Branch switch to clean water.

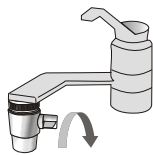

Turn upward

- 2** Before production, press the button to choose the desired kind of water.



Buttons of water quality

- 3** Turn stopcock on.

- 4** Water flowing (after 2 beeps of the device, you may drink the water from outlet pipe)

If you press a button to choose which kind of alkaline water. For example "first time", "rice cooking", "daily usage", and "cooking"; There's alkaline water from outlet pipe. And there's acid water from drainage pipe.

If you press the button named "Clean water", there is clean water from both outlet pipe and drainage pipe.

If you press one of the buttons named "Beauty" or "Washing", There's alkaline water from outlet pipe. And there's alkaline water from drainage pipe.

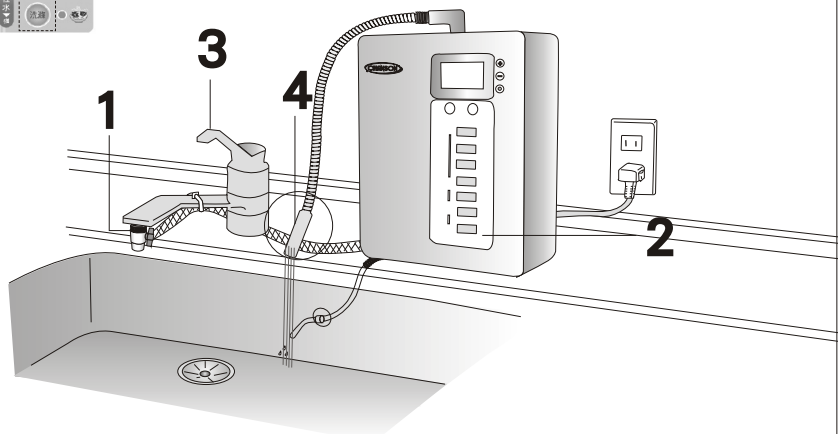

## Cleaning the electro bath

### The instruction of operation

#### Instruction :

In order to lengthen the life of electrolyzed-water treatment device and to function well, At a certain condition (by water quality) the indicator of "Reverse Cleaning" will turn to red light to notify that it's time to reverse cleaning.

Please follow the steps :

- 1 · Turn stopcock on.
- 2 · Press the button named "Reverse Cleaning".
- 3 · During reverse cleaning, the indicator will flash with flute alarms.
- 4 · The duration is about 1 minute (Before completing automatic cleaning, do not turn off the water supply.)
- 5 · During cleaning, do not drink the water from drainage pipe and outlet pipe.
- 6 · When to complete the cleaning, indicator light will turn off, then it's ready to produce water.

# Using the device PL-220/222

## The instruction of control panel

When "Reverse Cleaning" indicator light is on (red light) , it implies the need for electrode cleaning.(the procedure about electrode cleaning, see page.7)

When the LOCK indicator light is on, it implies that the kind of water is locked.

"Reverse Cleaning" button, Press this button to start the electrode cleaning. (The procedure about electrode cleaning, see Page.8)

"Clean water" button/ "RESET" button To press this button and still 5 seconds will beep once and reset the counter of filter .

LOCK Button (the kind of water is locked) Whenever the water flowing from outlet is locked at a certain kind of water quality. To press this button and still 5 seconds will cause the lock of water quality. To press this button and still 5 seconds again will unlock it.

"FILTER indicator" light When green light, it implies that the life of filter is long enough. When red light, it implies that you must replace filter. (the procedure of replacing filter, see Page.7)

CHANSON  
逆洗 LOCK  
料理 日常 煮飯 初期  
淨水  
淨化 洗滌  
濾芯指示  
PL-220

## The instruction of kinds of electrolyzed water

Usage	Alkaline water	PH-value
Cooking	Remove the odor of kelp and burdock. And rice and vegetables are more delicious.	About 9.5 ~ 9.7
Daily usage	It's for daily drinking and also good for chronic disease to improve the uncomfortable feeling about stomach, constipation, diarrhea, and gout and prevent from aging.	About 9.0 ~ 9.5
Rice Cooking	It's good for people used to drink alkaline electrolyzed water and also good for people of 35 ~ 45 years old. The taste is more abundant for tea or coffee brewing. And improve the uncomfortable feeling of the tiredness and shortage of sleep.	About 8.5 ~ 9.0
First time	It's for people to drink for the first time. It's also good for people of 20 ~ 35 years old. To balance of acid and alkaline and prevent from aging.	About 8.0 ~ 8.5 (it may vary depend on water quality or water pressure)

**Clean water**

Medicine is for preparing milk or taking medicine.

Usage	Acid water	PH-value
Beauty	It's for deep cleaning beneath the skin's surface and deep pore cleaning.	About 5.5 ~ 6.0
Washing	It's anti-bacteria for floor cleaning, dishes cleaning	About 5.0 ~ 5.5

※The pH-value mentioned in the table may vary depend on different water quality and different water pressure.

# Troubleshooting of PL-220 and PL-222

## Indicator light

## The causes and actions

Both (Beauty) and (Washing) indicator lights are on and beeps short beeps as alert.



The temperature of water from inlet is too high. Turn off the inlet and confirm the temperature is below 35? and then begin to use again.

All of indicator lights are on and beeps short beeps as alert.



The temperature of device is too high. Please shut down the device for 30 minutes and then use again. If still not function well, contact the service providers.

The kind of water quality in dicator lights which are named "First time", "Rice cooking", "Daily usage", and "Cooking" are on, and beeps short beeps as alert



The current of power is too high. Please contact the service providers.

The indicator light named "Clean Water" is on. And beep 2 short beeps and 1 long beep as alert.



The water flow reaches the maximum limitation. Turn down the inlet valve to reduce water supply.

# Using the control panel of PL-320/325/520/525

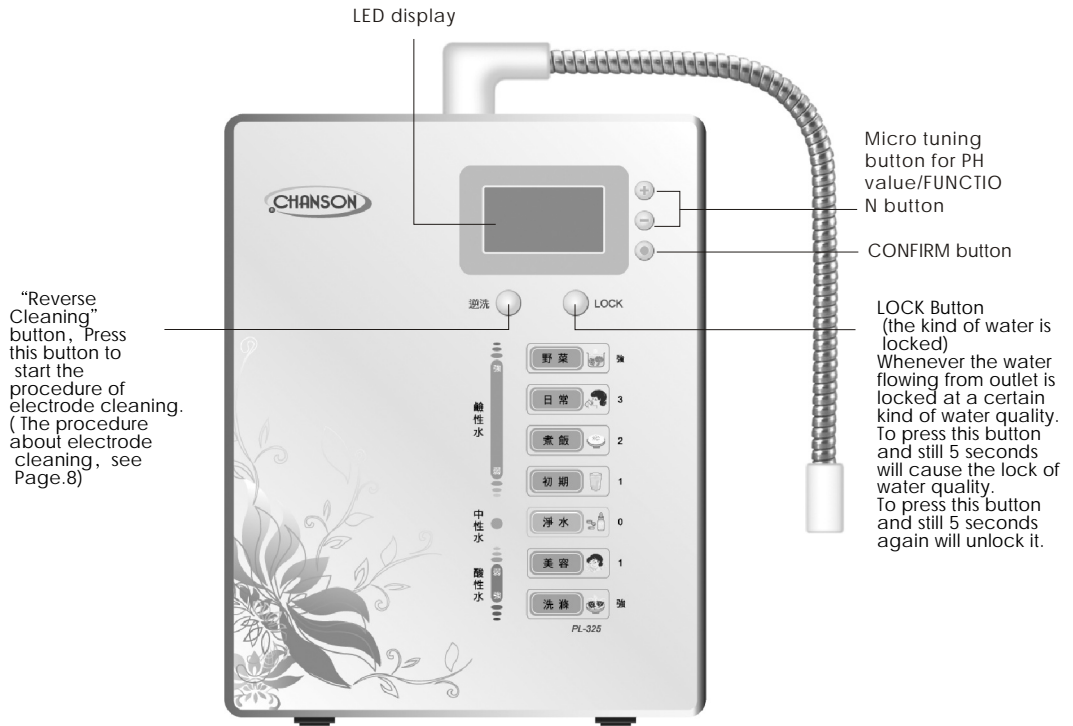

The appearance of electrolyzed-water treatment device.

## The instruction of kinds of electrolyzed water

Usage	Alkaline water	PH-value
Cooking	Remove the odor of kelp and burdock. And rice and vegetables are more delicious.	About 9.5 - 9.7
Daily usage	It's for daily drinking and also good for chronic disease to improve the uncomfortable feeling about stomach, constipation, diarrhea, and gout and prevent from aging.	About 9.0 - 9.5
Rice Cooking	It's good for people used to drink alkaline electrolyzed water and also good for people of 35 - 45 years old. The taste is more abundant for tea or coffee brewing. And improve the uncomfortable feeling of the tiredness and shortage of sleep.	About 8.5 - 9.0
First time	It's for people to drink for the first time. It's also good for people of 20 - 35 years old. To balance of acid and alkaline and prevent from aging.	About 8.0 - 8.5

	Clean water	
Medicine	is for preparing milk or taking medicine.	

	Acid water	
Usage		PH-value
Beauty	It's for deep cleaning beneath the skin's surface and deep pore cleaning.	About 5.5 - 6.0
Washing	It's anti-bacteria for floor cleaning, dishes cleaning	About 4.0 - 5.5

※ The pH-value mentioned in the table may vary depend on different water quality and different water pressure.

# Using the control panel of PL-725

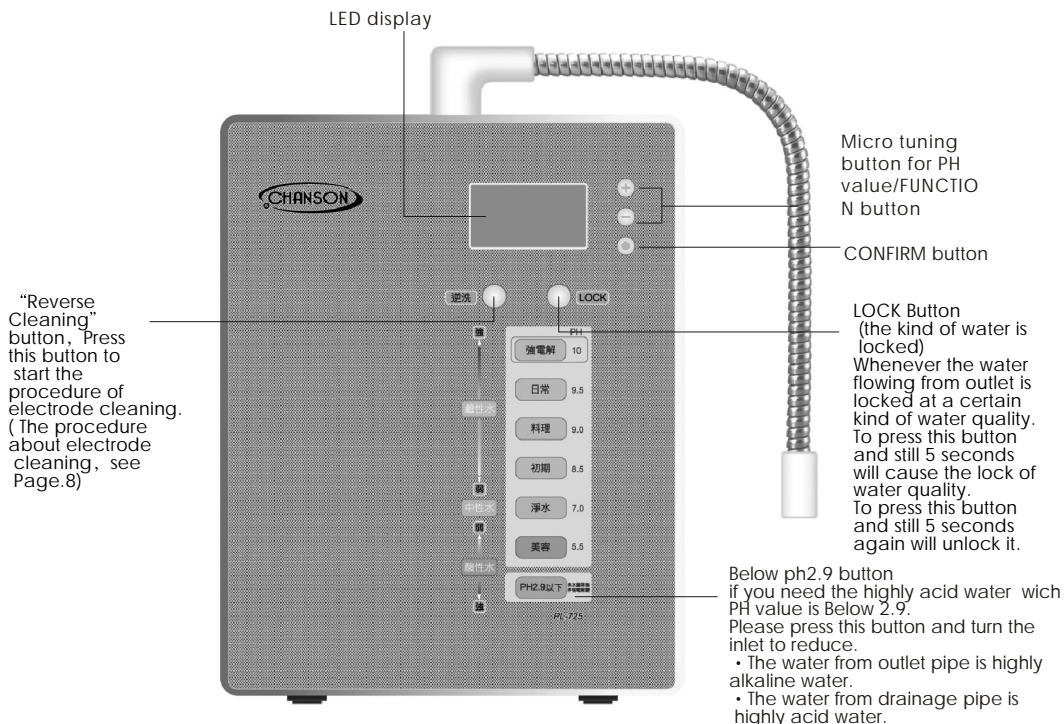

The appearance of electrolyzed-water treatment device.

## The instruction of kinds of electrolyzed water

### Alkaline water

Usage

PH-value

Highly Electrolyzed

Fruit cleaning : remove insecticides.  
Dishes cleaning : remove oil sludge  
Clothes cleaning : remove stains on the collars

Over 10

Daily usage

It's for daily drinking and also good for chronic disease to improve the uncomfortable feeling about stomach, constipation, diarrhea, and gout and prevent from aging.

About 9.0-9.8

Rice

It's good for people used to drink alkaline electrolyzed water and also good for people of 35-45 years old.  
The taste is more abundant for tea or coffee brewing.  
And improve the uncomfortable feeling of the tiredness and shortage of sleep.

About 8.5-9.0

First time

It's for people to drink for the first time. It's also good for people of 20-35 years old.  
To balance of acid and alkaline and prevent from aging.

About 8.0-8.5

### Clean water

Medicine

is for preparing milk or taking medicine.

### Acid water

Usage

PH-value

Beauty

It's for deep cleaning beneath the skin's surface and deep pore cleaning.

About 5.5-6.0

### Highly acid water

Usage

PH-value

Below pH 2.9

It's anti-bacteria for floor cleaning, dishes cleaning.

Below pH 2.9

※ The pH-value mentioned in the table may vary depend on different water quality and different water pressure.

# The instruction of LED display for PL-320/325/520/525/725

## The setting of LED display

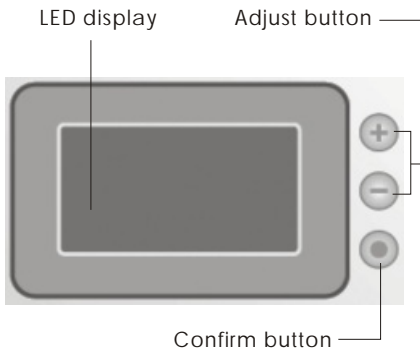

The setting of LED display		Default value
format adjustment	Display of clock or numeric value	00 : 00
Lock Button	Secure the water quality of you want.	Unlock
Micro tuning for pH-value	Adjust the PH-value that you want to drink	Default
RESET filter counter	Reset the counter of Filter	Varies depend on water quality
Volume Adjustment	To adjust the volume of flute alert (PL-320/325 do not have this function)	15
EXIT	Exit the menu	

## The instruction of Micro tuning for pH-value

※This function only can be operated with inlet water.

### The instruction :

- 1 · Turn on the inlet water.
- 2 · Press +/- buttons to set the pH-value of outlet water.
- 3 · Turn off the inlet water and then return to the default value of pH-value.

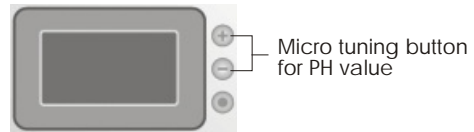

## How to secure the water quality

※The operation can only be executed when the device is filled with water.

### The instruction to LOCK

- 1 · Press +/- button to set the pH-value which you want.
- 2 · To press LOCK button and hold for 5 seconds will cause the indicator "LOCK" which appears at top right display and a flute beep as alert to finish to LOCK the setting.

### The instruction of UNLOCK

- 1 · To press LOCK button and hold for 5 seconds will cause the indicator "LOCK" which disappears at top right display and a flute beep as alert to finish to UNLOCK the setting.

# The instruction of LED display for PL-320/325/520/525/725

## The instruction of functions

### Operations

### LED display

#### Item

Operations under turn off inlet water

- 1 Press either  $\oplus$  button or  $\ominus$  buttons to enter  
Press  $\oplus$  and  $\ominus$  buttons to choose (the item you want to set) and press  $\bullet$  button to confirm.
- 2 Press  $\oplus$  and  $\ominus$  button to choose (the item you want to set) and press  $\bullet$  button to confirm.
- 3 Press  $\oplus$  and  $\ominus$  buttons to choose (the item you want to set) And press  $\bullet$  button to confirm.
- 4 Press  $\oplus$  and  $\ominus$  buttons to exit to finish setting.

#### Display

Ex : to set the display of time as numeric

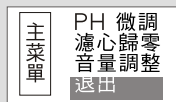
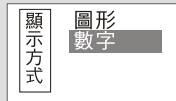
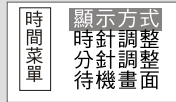
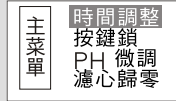

#### The adjustment of hour hand

Ex : to set the hour of clock to 10 o'clock.

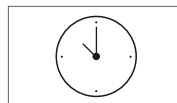
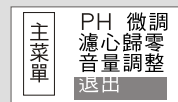
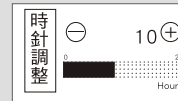
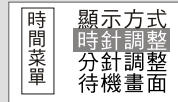
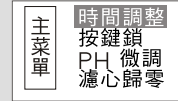

The screen of standby



# The instruction of functions

## LED display

### Set the minute of clock

Ex : to set the minute of clock as 30 minutes.

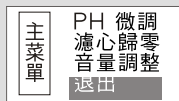
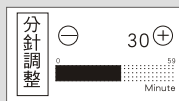
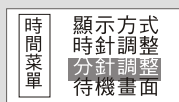
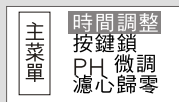

### Set the standby screen

Ex : to set the "Standby screen" to disappear.

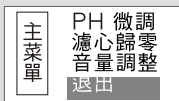
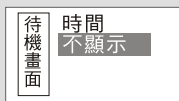
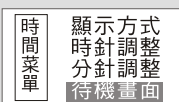
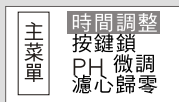

The screen of standby

# The instruction of LED display for PL-320/325/520/525/725

## The instruction of functions

### Operations

### LED display

#### Item

Operations under turn off inlet water

- 1** Press either  $\oplus$  button or  $\ominus$  buttons to enter  
Press  $\oplus$  and  $\ominus$  buttons to choose (the item you want to set) and press  $\bullet$  button to confirm.
- 2** Press  $\oplus$  and  $\ominus$  button to choose (the item you want to set) and press  $\bullet$  button to confirm.
- 3** Press  $\oplus$  and  $\ominus$  buttons to choose (the item you want to set) And press  $\bullet$  button to confirm.
- 4** Press  $\oplus$  and  $\ominus$  buttons to exit to finish setting.

#### LOCK Button

Ex : to SECURE the water quality.

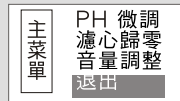
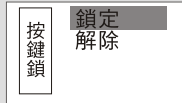
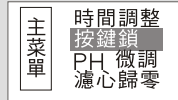
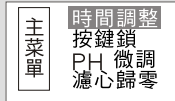

#### Micro tuning for pH-value

Ex : To set the water quality to "Daily usage." The original pH-value is 9.5 and adjust the pH-value to 9.8.

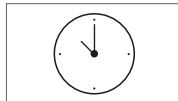
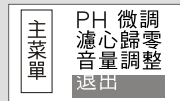
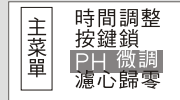
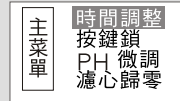

The screen of standby

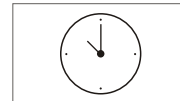

The screen of standby

## The instruction of functions

### RESET the counter of filter

Ex : to reset the counter of filter.

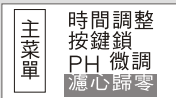
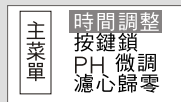

確認執行？

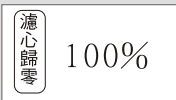

The screen of standby

### Adjust the volume

※PL-320/326 do not have this function.

Ex : to set the volume of flute to 10.

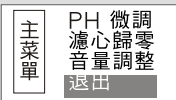
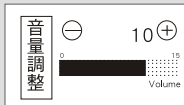
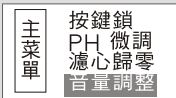
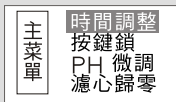

The screen of standby

# The instruction of LED display for PL-320/325/520/525/725

## The instruction of LED display

### System boot Screen



### When Reverse cleaning

※the procedure of electrode board cleaning, see page.8.

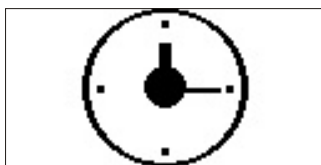
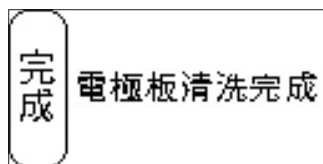
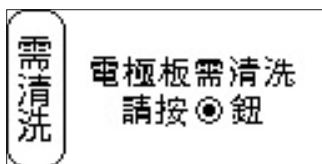

或

12 : 15

※Return to the standby screen after Reverse Cleaning.

### The display of remain life of filter

※The procedure of changing filter, see page.7.

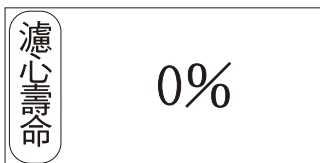
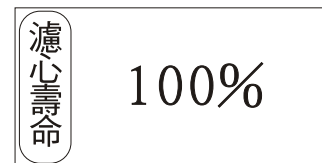

# The instruction of LED display for PL-320/325/520/525/725

## Sections of water quality and the messages on LED display



※The pH-value, ORP value, the remain life of filter in the figure is for simulation.

# The instruction of LED display for PL-320/325/520/525/725

## Sections of water quality and the messages on LED display

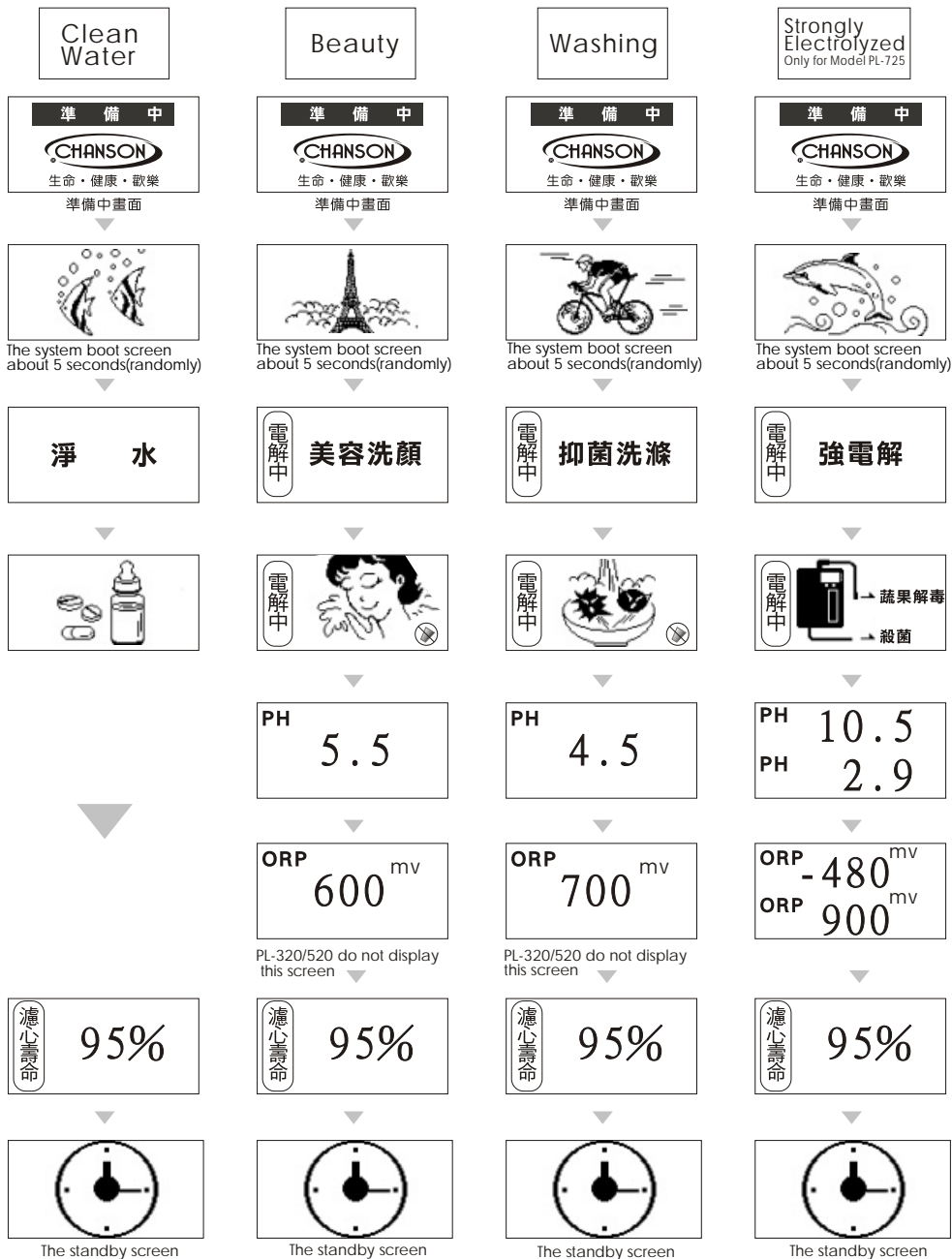

※The pH-value, ORP value, the remain life of filter in the figure is for simulation.

# Troubleshooting for PL-320/325/520/525/725

## Alert message



水溫過高

- ▶ The temperature of water from inlet is too high. Turn off the inlet and confirm the temperature is below 35° and then begin to use again.



機體過熱保護

- ▶ The temperature of device is too high. Please shut down the device for 30 minutes and then use again. If still not function well, contact the service providers.



電解槽異常

- ▶ 1 · The current of power is too high.  
2 · No current of power (by electrode tank protection) Please contact the service providers.



水量限制調整

進水量調大

- ▶ The water flow reaches the minimum limitation. Turn the inlet valve up.



水量限制調整

進水量調小

- ▶ The water flow reaches the maximum limitation. Turn the inlet valve down.

# The specification of PL-220/222/320/325/520/525/725

Model	PL-220	PL-222	PL-320	PL-325	PL-520	PL-525	PL-725
Voltage	110V (Customization 220V)	110V (Customization 220V)	110V (Customization 220V)	110V (Customization 220V)	110V (Customization 220V)	110V (Customization 220V)	110V (Customization 220V)
Width*Height *depth (cm)	22.5*33*12	22.5*33*12	22.5*33*12	22.5*33*12	22.5*33*12	22.5*33*12	22.5*33*12
Weight (kg)	About 4.63	About 4.63	About 4.63	About 4.63	About 4.8	About 4.8	About 4.95
Number of electrode tanks	3	3	3	3	5	5	7
Consumed power (Watt)	3~150	3~150	3~150	3~150	3~150	3~150	3~150
The display of cleaning	Indicator light	Indicator light	LCD display	LCD display	LCD display	LCD display	LCD display
Sections of water quality	4sections of alkaline water	4sections of alkaline water	4sections of alkaline water	4sections of alkaline water	4sections of alkaline water	4sections of alkaline water	4sections of alkaline water
	1 section of clean water	1 section of clean water	1 section of clean water	1 section of clean water	1 section of clean water	1 section of clean water	1 section of clean water
	2 sections of acid water	2 sections of acid water	2 sections of acid water	2 sections of acid water	2 sections of acid water	2 sections of acid water	2 sections of acid water
Deoxidization potential (mV)	About -150~ 250 (varies depend on water quality)	About -150~ 250 (varies depend on water quality)	About -150~ 350 (varies depend on water quality)	About -150~ 350 (varies depend on water quality)	About -150~ 430 (varies depend on water quality)	About -150~ 430 (varies depend on water quality)	About -150~ 600 (varies depend on water quality)
LCD display	None	None	3 colors LCD	3 colors LCD	5 colors LCD	5 colors LCD	6 colors LCD
The display of remain life of filter	Indicator light	Indicator light	LCD display	LCD display	LCD display	LCD display	LCD display
The material of filter							
The display of pH-value			●	●	●	●	●
The display of ORP value				●		●	●



## Operations during the suspension period of water supply or electric power

---

### ▶ During the suspension period of electric power :

- 1 · During operation : Turn off the stopcock.
- 2 · During the suspension : Turn on inlet water and use the clean water from outlet pipe. The water from outlet pipe is filtered by filter.
- 3 · After the suspension : Please follow the normal procedure to operate.
- 4 · The setting except timer and remain life of filter will be kept during the suspension.

### During the suspension period of water supply :

- 1 · During the suspension period of water supply : MUST turn off the stopcock and set the branch switch to the original position.
- 2 · After the suspension period of water supply : Confirm the branch switch is on the original position. And then turn on the stopcock and flow water freely for 1 ~ 2 minutes to drain the air and dirt from the pipes. That may cause damage of filter if air or any dirt in filter.

# Filter maintenance record

---

Items Date	(Pre-filter) The first filter	(Pre-filter) The second filter	Inner filter	Maintenance of Electrode tank



# CHANSON series for water purification

- Reverse Osmosis water purifiers
  - Electrolyzed water devices
  - Hollow fiber membrane
- Home water treatment devices
  - Water boilers
  - Water boilers/tower type
- Fruit and vegetable Sterilizers
  - Ozone air cleaners
  - Ceramic water purifiers
- Reverse Osmosis water purifiers for industry purpose



**CHANSON Co., Ltd. of water purification**  
2F, No.88-11, Sec. 1, Guangfu Rd., Sanchong City, Taipei  
County 241, Taiwan (R.O.C.)  
TEL : (02)8511-2222  
<http://www.cswater.com.tw>

Taipei Branch:	No.226, Sec. 4, Bade Rd., Songshan District, Taipei City 105, Taiwan (R.O.C.)	(02)2528-6008
Wan-Long Branch:	No.148, Sec. 5, Roosevelt Rd., Wunshan District, Taipei City 116, Taiwan (R.O.C.)	(02)8931-2777
San-Jhong Branch:	No.83, Jhengyi N. Rd., Sanchong City, Taipei County 241, Taiwan (R.O.C.)	(02)8985-3333
Jhong-He Branch:	No.676, Jingping Rd., Jhonghe City, Taipei County 235, Taiwan (R.O.C.)	(02)2242-7222
Tu-Cheng Branch:	No.388, Sec. 2, Jincheng Rd., Tucheng City, Taipei County 236, Taiwan (R.O.C.)	(02)2262-7999
Jhong-Li Branch:	No.110, Sec. 1, Yanping Rd., Pingjhen City, Taoyuan County 324, Taiwan (R.O.C.)	(03)427-1700
Sin-Jhu Branch:	No.118, Sec. 2, Jhonghua Rd., Hsinchu City 300, Taiwan (R.O.C.)	(03)531-9111
Taichung Branch:	No.395, Jhongming S. Rd., West District, Taichung City 403, Taiwan (R.O.C.)	(04)2375-8222
Yuan-Lin Branch:	No.390, Sec. 1, Jhongshan Rd., Yuanlin Township, Changhua County 510, Taiwan (R.O.C.)	(04)832-9000
Jia-Yi Branch:	No.434, Sec. 2, Bo-ai Rd., Chiayi City 600, Taiwan (R.O.C.)	(05)234-6600
Tainan Branch(1st):	No.170, Jhongjheng S. Rd., Yongkang City, Tainan County 710, Taiwan (R.O.C.)	(06)281-9900
Kaoshung Branch:	No.107, Minzu 1st Rd., Sanmin District, Kaohsiung City 807, Taiwan (R.O.C.)	(07)313-1111
Si-Jhih Branch:	No.268, Sec. 2, Datong Rd., Sijhih City, Taipei County 221, Taiwan (R.O.C.)	(02)8646-1111
Taoyuan Branch:	No.245, Sec. 1, Jieshou Rd., Bade City, Taoyuan County 334, Taiwan (R.O.C.)	(03)3770677
Tainan Branch(2nd):	No.126, Sec. 1, Jiankang Rd., West Central District, Tainan City 700, Taiwan (R.O.C.)	(06)214-7075